

Colburn Lab Ground Floor (Lower Level)

Updated Sep. 21, 2021

Color Chart

- CBE Grad Student
- Researcher
- Temp. Occupant
- Arriving Soon

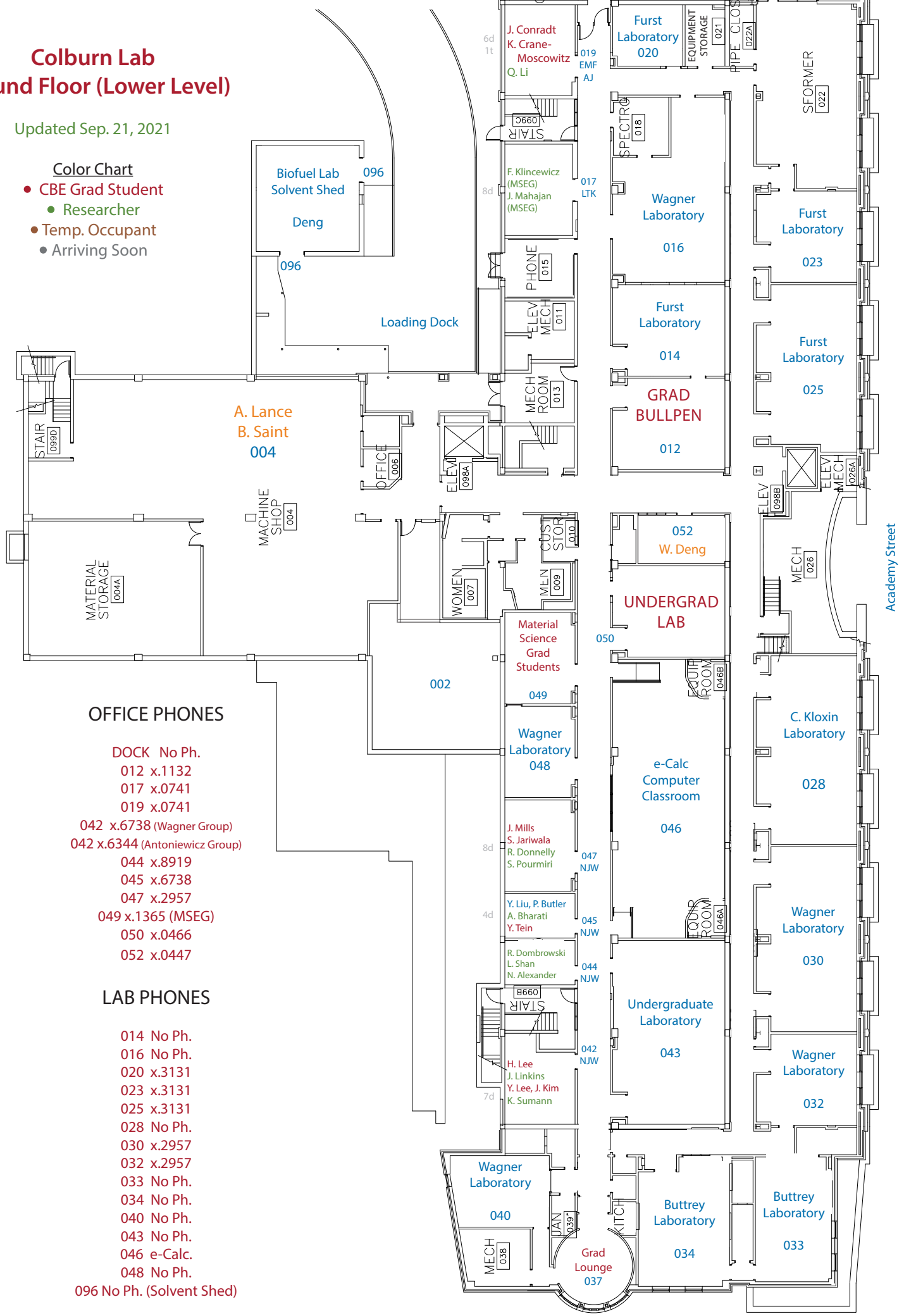

OFFICE PHONES

- DOCK No Ph.
 012 x.1132
 017 x.0741
 019 x.0741
 042 x.6738 (Wagner Group)
 042 x.6344 (Antoniewicz Group)
 044 x.8919
 045 x.6738
 047 x.2957
 049 x.1365 (MSEG)
 050 x.0466
 052 x.0447

LAB PHONES

- 014 No Ph.
 016 No Ph.
 020 x.3131
 023 x.3131
 025 x.3131
 028 No Ph.
 030 x.2957
 032 x.2957
 033 No Ph.
 034 No Ph.
 040 No Ph.
 043 No Ph.
 046 e-Calc.
 048 No Ph.
 096 No Ph. (Solvent Shed)

Colburn Lab First (1st) Floor

Updated Sep. 15, 2021

Color Chart

- CBE Grad Student
- Researcher
- Temp. Occupant
- Arriving Soon

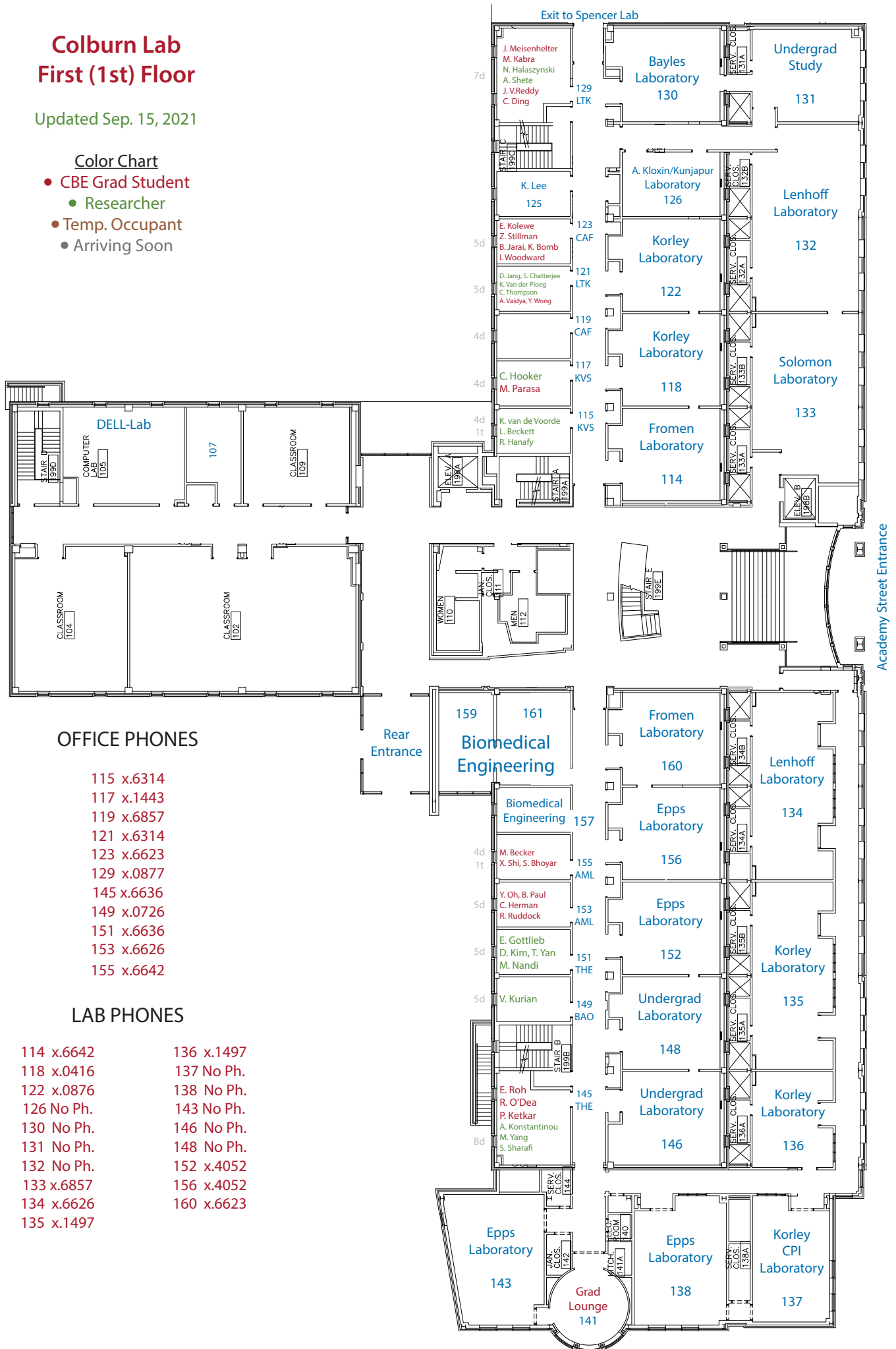

OFFICE PHONES

- 115 x.6314
- 117 x.1443
- 119 x.6857
- 121 x.6314
- 123 x.6623
- 129 x.0877
- 145 x.6636
- 149 x.0726
- 151 x.6636
- 153 x.6626
- 155 x.6642

LAB PHONES

- | | |
|------------|------------|
| 114 x.6642 | 136 x.1497 |
| 118 x.0416 | 137 No Ph. |
| 122 x.0876 | 138 No Ph. |
| 126 No Ph. | 143 No Ph. |
| 130 No Ph. | 146 No Ph. |
| 131 No Ph. | 148 No Ph. |
| 132 No Ph. | 152 x.4052 |
| 133 x.6857 | 156 x.4052 |
| 134 x.6626 | 160 x.6623 |
| 135 x.1497 | |

Colburn Lab Second (2nd) Floor

Updated Sep. 28, 2021

Color Chart

- CBE Grad Student
- Researcher
- Temp. Occupant
- Arriving Soon

OFFICE PHONES

219 x.4528
240 x.0382
253 x.6851

LAB PHONES

208 No Ph.
212 x.8941
216 No Ph.
220 x.4132
221 x.4132
243 x.1049
244 No Ph.
245 No Ph.
246 No Ph.
251 x.0240
254 No Ph.
256 No Ph.
260 x.0240



9d
219
AMK
CJK

6d
253
MOS

Academy Street

Colburn Lab Third (3rd) Floor

Updated Oct. 05, 2021

Color Chart

- CBE Grad Student
- Researcher
- Temp. Occupant
- Arriving Soon

OFFICE PHONES

- 309 No Ph.
- 311 x.1243
- 313 x.2213
- 315 x.6572
- 317 x.6726
- 321 x.6657
- 347 x.4741
- 351 x.2347
- 353 x.7650
- 355 No Ph.
- 357 No Ph.
- 359 x.0875
- 361 x.6556
- 363 No Ph.
- 365 x.4416
- 366 x.3036

LAB PHONES

- 306 x.6964
- 310 No Ph.
- 314 No Ph.
- 318 x.6123
- 322 x.6123
- 323 No Ph.
- 336 x.2603
- 337 x.2263
- 338 No Ph.
- 339 x.1454
- 340 No Ph.
- 345 No Ph.
- 348 No Ph.
- 350 No Ph.
- 354 No Ph.
- 358 No Ph.
- 362 No Ph.

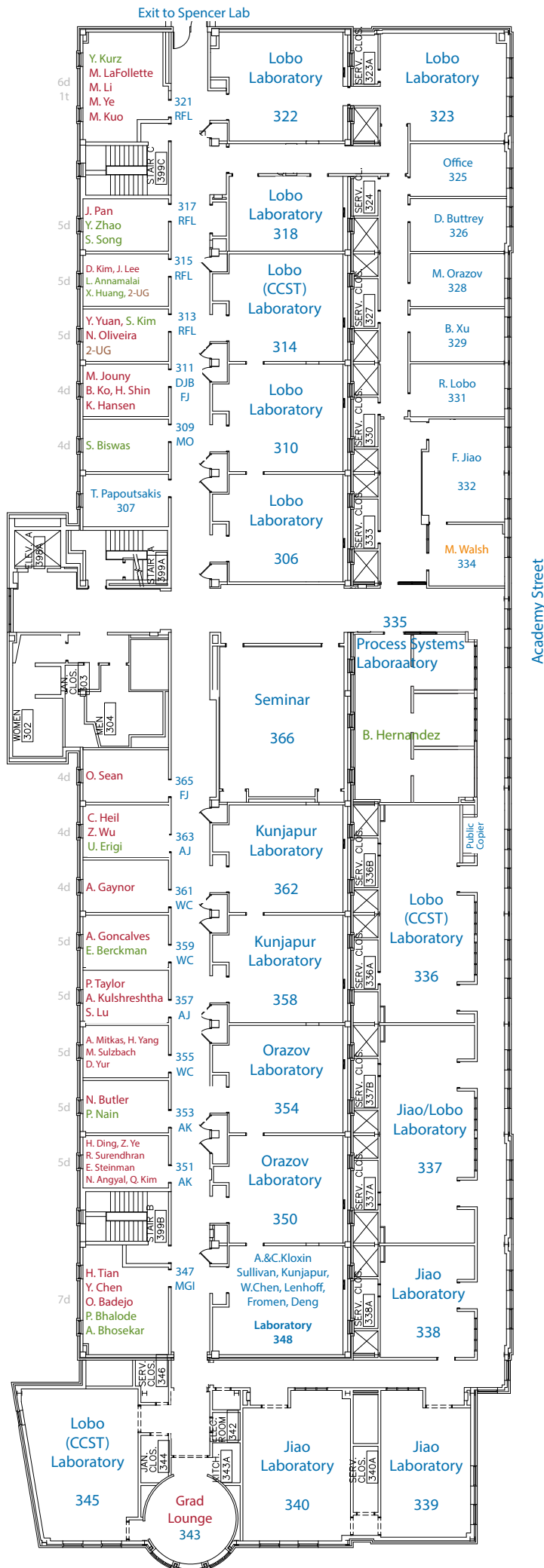

Academy Street

Exit to Spencer Lab